

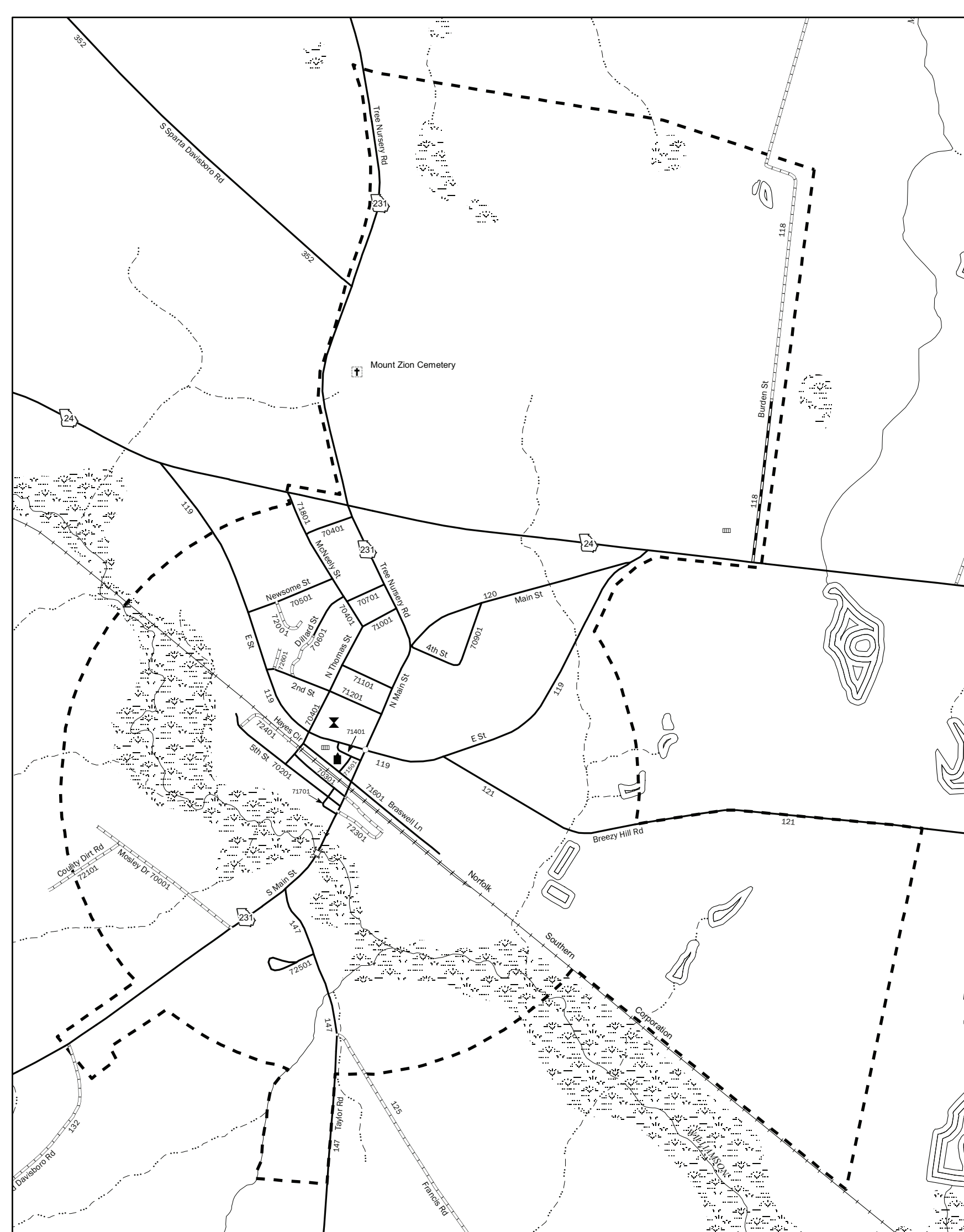

Davisboro



Harrison



Oconee

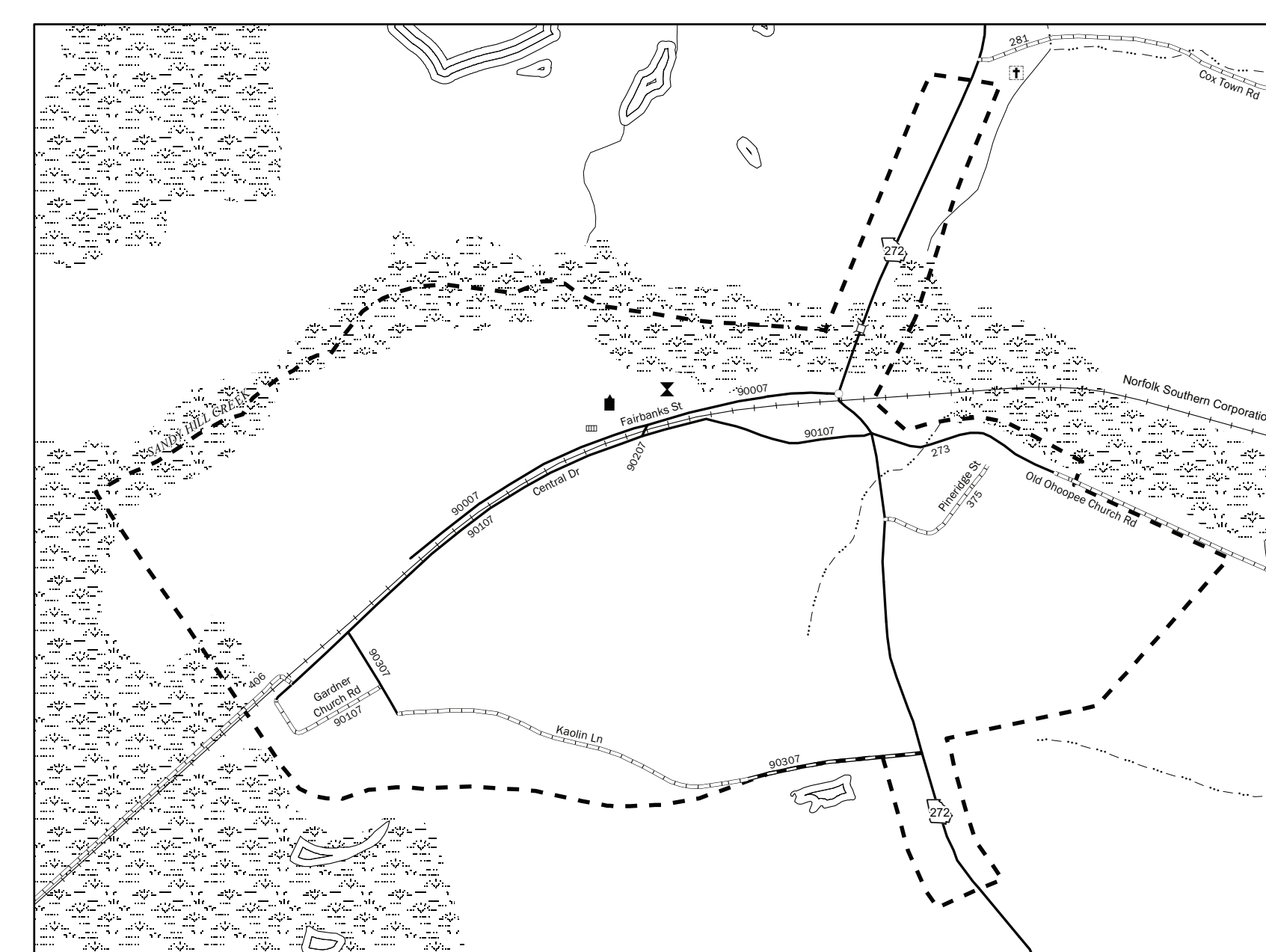

Deepstep

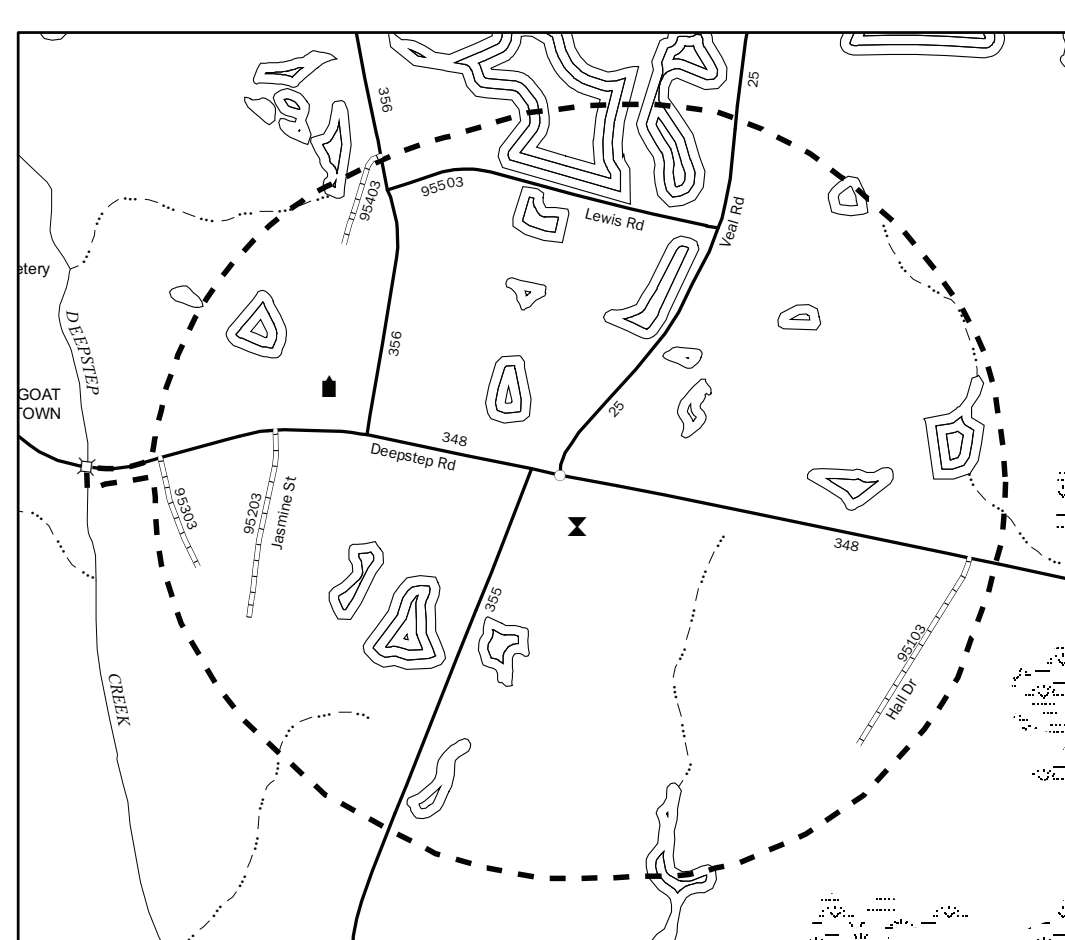

Ridgelyville

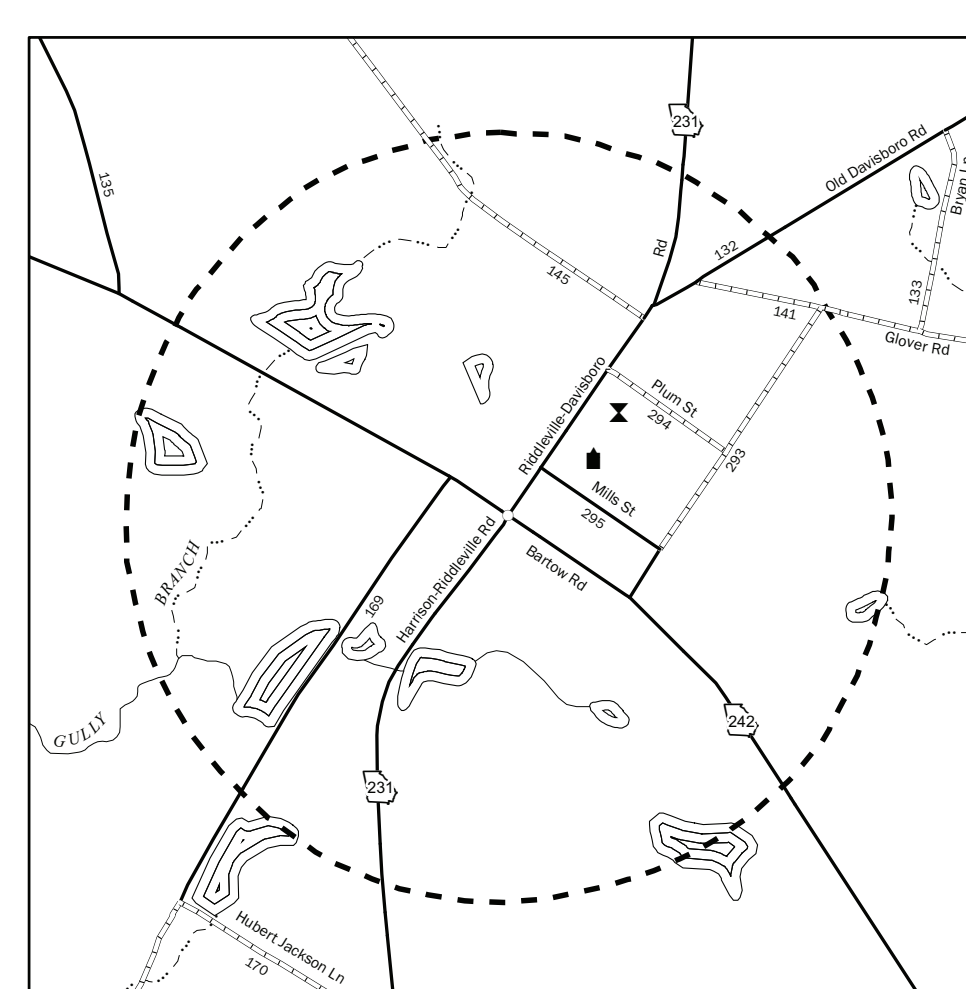

Tennille



COUNTY MAP DISCLAIMER: THE GEORGIA DEPARTMENT OF TRANSPORTATION MAKES NO REPRESENTATION OR WARRANTIES, IMPLIED OR EXPRESSED, CONCERNING THE ACCURACY, COMPLETENESS, RELIABILITY OR SUITABILITY FOR ANY PARTICULAR PURPOSE OF THIS INFORMATION AND DATA CONTAINED IN THIS MAP.

WHILE EFFORTS HAVE BEEN MADE TO ENSURE THAT INFORMATION REPRESENTED ON THIS MAP IS AS ACCURATE AS POSSIBLE, THIS MAP REPRESENTS THE BEST AVAILABLE SPATIAL DATA AS OF JUNE 2009. IF THERE IS A DISCREPANCY BETWEEN THE DATA REPRESENTED ON THIS MAP AND THE WRITTEN RECORD OF THE STATE HIGHWAY SYSTEM AND COUNTY ROAD SYSTEM, THE OFFICIAL WRITTEN RECORD (PER STATE CODE 32-4-3) SHALL HAVE PRECEDENCE.

IN ADDITION, PLEASE NOTE THAT PROMISED STATE ROUTE CORRIDORS OR EXISTING ROUTES THAT WERE DESIGNATED WITH TEMPORARY STATE ROUTE DESIGNATIONS AT THE TIME OF MAP PRODUCTION MAY NOT BE REPRESENTED.

FOR ADDITIONAL INFORMATION OR ACCESS TO THE WRITTEN RECORDS, PLEASE CONTACT THE OFFICE OF TRANSPORTATION DATA AT (770) 986-1360 OR BY EMAIL AT OTD@dot.ga.gov.

A LIST OF MAPS CREATED AND MAINTAINED BY THE DEPARTMENT OF TRANSPORTATION IS AVAILABLE. FOR MORE INFORMATION PLEASE VISIT <http://www.dot.ga.gov>.

ALL URBAN AREA BOUNDARIES AND TRANSPORTATION FEATURES INCLUDING ROUTES, BRIDGES, RAILROADS, AIRPORT RUNWAYS, HELIPADS AND SHIELDS ARE PROVIDED BY GEORGIA DEPARTMENT OF TRANSPORTATION. FOR MORE INFORMATION PLEASE VISIT <http://www.dot.ga.gov>.

ALL HYDROGRAPHY FEATURES ARE PROVIDED BY THE UNITED STATES GEOLOGICAL SURVEY NATIONAL HYDROGRAPHY DATASET. FOR MORE INFORMATION PLEASE VISIT <http://www.usgs.gov>.

ALL COUNTY AND CITY BOUNDARIES ARE PROVIDED BY THE GEORGIA DEPARTMENT OF COMMUNITY AFFAIRS. FOR MORE INFORMATION PLEASE VISIT <http://www.dca.ga.gov>.

ALL STATE PROPERTY BOUNDARIES ARE PROVIDED BY THE GEORGIA DEPARTMENT OF NATURAL RESOURCES. FOR MORE INFORMATION PLEASE VISIT <http://www.dnr.ga.gov>.

ALL HOSPITAL LOCATIONS ARE PROVIDED BY THE GEORGIA DEPARTMENT OF COMMUNITY HEALTH. FOR MORE INFORMATION PLEASE VISIT <http://dch.georgia.gov>.

ALL PUBLIC K-12 SCHOOL LOCATIONS ARE PROVIDED BY THE GEORGIA GIS DATA CLEARINGHOUSE. FOR MORE INFORMATION PLEASE VISIT <http://www.ga.state.gov>.

ALL NATIONAL PARK AND NATIONAL FOREST BOUNDARIES ARE PROVIDED BY THE NATIONAL PARK SERVICE. FOR MORE INFORMATION PLEASE CONTACT <http://www.nps.gov>.

ALL COMMUNITY LOCATIONS AND COUNTY SEAT LOCATIONS ARE PROVIDED BY THE UNITED STATES GEOLOGICAL SURVEY GEOGRAPHIC NAMES INFORMATION SYSTEM. FOR MORE INFORMATION PLEASE VISIT <http://geonames.usgs.gov>.

ALL FIRE STATION, LIBRARY, CORRECTIONAL FACILITY, LAW ENFORCEMENT, COURTHOUSE, COLLEGE, UNIVERSITY AND PRIVATE SCHOOL LOCATIONS PROVIDED BY THE GEORGIA DEPARTMENT OF COMMUNITY AFFAIRS. FOR MORE INFORMATION PLEASE VISIT <http://www.dca.ga.gov>.

© 2010 GEORGIA DEPARTMENT OF TRANSPORTATION. ALL RIGHTS RESERVED. ANY REPRODUCTION IN PART OR IN WHOLE IS PROHIBITED UNLESS AUTHORIZED BY THE GEORGIA DEPARTMENT OF TRANSPORTATION.

LEGEND

Helipad	County Road Number	Unpaved Road
Wellhead	Community	County Seat
Courthouse	County Boundary	Interstate
National/State Land	City Boundary	State Route Number
Divided Hwy	Population (2000 Census)	Elevation
National Register	Historical Place	Paved Road
State Route Number		County Seat
Military Reservation		Bituminous Road
Lake		Weight Station
Lighthouse		Library
Fish Hatchery		City Hall
Urban Area Boundary		Correctional Facility
Perennial Stream		Law Enforcement
School		Road Area
US Route Number		Swamp/Marsh
Public Road Number		State Capitol
Scenic Byway		Hospital
Bridge		Railroad
Firestation		Projected Alignment
		Cemetery

GENERAL HIGHWAY MAP
WASHINGTON COUNTY
GEORGIA

PREPARED BY THE
DEPARTMENT OF TRANSPORTATION
OFFICE OF TRANSPORTATION DATA
IN COOPERATION WITH
U.S. DEPARTMENT OF TRANSPORTATION
FEDERAL HIGHWAY ADMINISTRATION
2010

