

Conyers

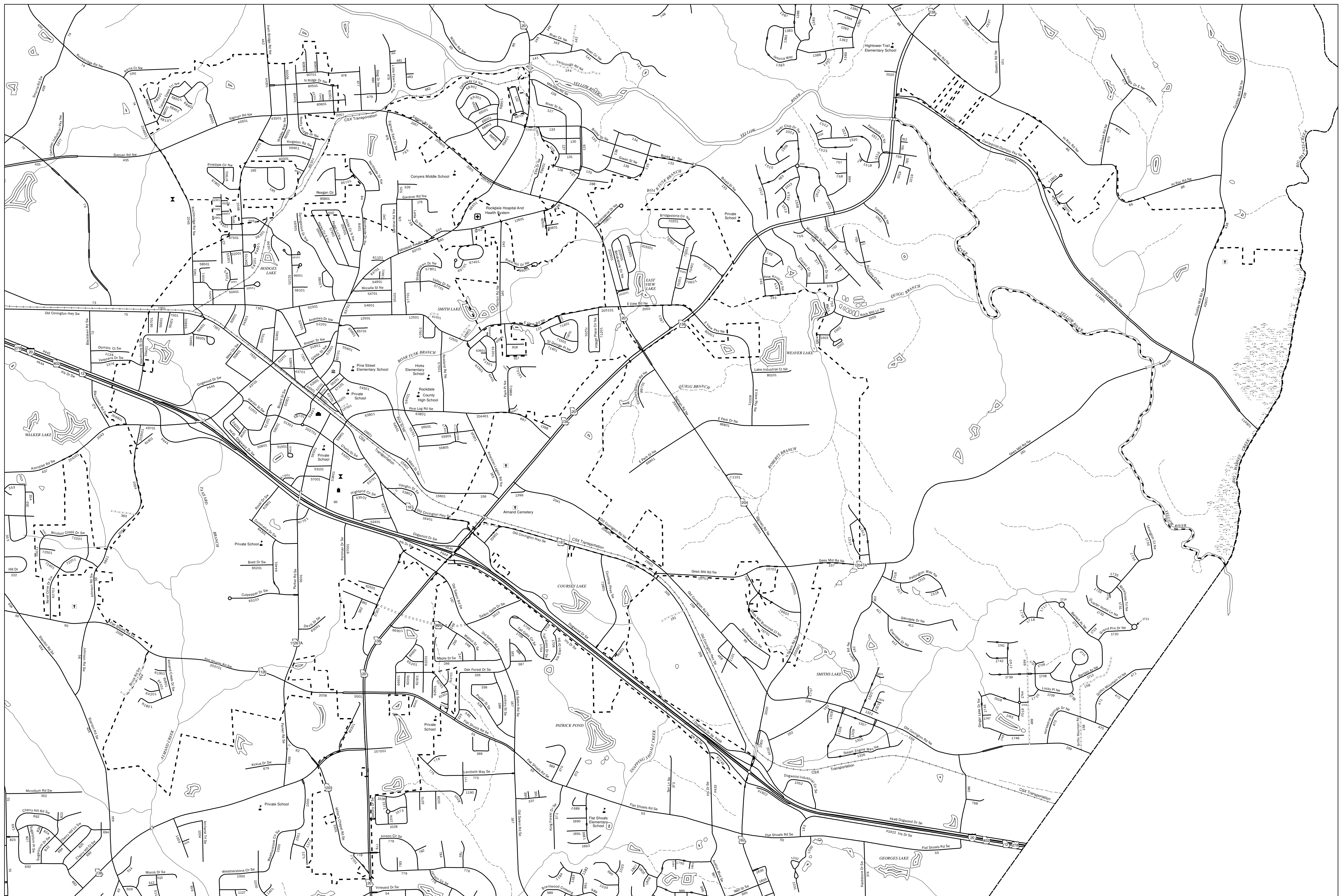

**COUNTY MAP DISCLAIMER:**  
THE GEORGIA DEPARTMENT OF TRANSPORTATION MAKES NO REPRESENTATION OR WARRANTY, IMPLIED OR EXPRESSED, CONCERNING THE ACCURACY, COMPLETENESS, RELIABILITY, OR SUSTAINABILITY FOR ANY PARTICULAR PURPOSE OF THIS INFORMATION AND DATA CONTAINED IN THIS MAP.

WHILE EFFORTS HAVE BEEN MADE TO ENSURE THAT INFORMATION REPRESENTED ON THIS MAP IS AS ACCURATE AS POSSIBLE, THIS MAP REPRESENTS THE BEST AVAILABLE SPATIAL DATA AS OF NOVEMBER 2010. IF THERE IS A DISCREPANCY BETWEEN THE DATA REPRESENTED ON THIS MAP AND THE WRITTEN RECORD OF THE STATE HIGHWAY SYSTEM AND COUNTY ROAD SYSTEM, THE OFFICIAL WRITTEN RECORD (PER STATE CODE 32-4-2) SHALL HAVE PRECEDENCE.

IN ADDITION, PLEASE NOTE THAT PROPOSED STATE ROUTE CORRIDORS OR EXISTING ROUTES THAT WERE DESIGNATED WITH TEMPORARY STATE ROUTE DESIGNATIONS AT THE TIME OF MAP PRODUCTION MAY NOT BE REPRESENTED.

FOR ADDITIONAL INFORMATION OR ACCESS TO THE WRITTEN RECORDS, PLEASE CONTACT THE OFFICE OF TRANSPORTATION DATA AT (770) 986-1360 OR BY EMAIL AT OTDCustomerService@dot.ga.gov.

A LIST OF MAPS CREATED AND MAINTAINED BY THE DEPARTMENT OF TRANSPORTATION IS AVAILABLE. FOR MORE INFORMATION PLEASE VISIT <http://www.dot.ga.gov>.

**ALL URBAN AREA BOUNDARIES AND TRANSPORTATION FEATURES INCLUDING ROUTES, BRIDGES, RAILROADS, AIRPORT RUNWAYS, HELIPADS AND SHIELDS ARE PROVIDED BY THE GEORGIA DEPARTMENT OF TRANSPORTATION.**

**THE URBAN AREA BOUNDARY (UAB) LINE WORK REPRESENTED ON THIS MAP WAS CREATED IN 2003 FOR THE PURPOSE OF RECLASSIFYING ROADS BASED ON THE RESULTS OF THE 2000 CENSUS. THIS MAY IN SOME CASES RESULT IN DISCREPANCIES BETWEEN THE ALIGNMENT OF THE UAB LINE WORK AND THE MORE CURRENT DEPARTMENT OF COMMUNITY AFFAIRS CITY LIMIT LINE WORK THAT HAS BEEN MODIFIED SINCE THAT TIME.**

**ALL HYDROGRAPHY FEATURES ARE PROVIDED FROM THE UNITED STATES GEOLOGICAL SURVEY NATIONAL HYDROGRAPHY DATASET. FOR MORE INFORMATION PLEASE VISIT <http://hnd.usgs.gov>.**

**ALL COUNTY AND CITY BOUNDARIES ARE PROVIDED BY THE GEORGIA DEPARTMENT OF COMMUNITY AFFAIRS. FOR MORE INFORMATION PLEASE VISIT <http://www.dca.state.ga.us>.**

**ALL STATE PROPERTY BOUNDARIES ARE PROVIDED BY THE GEORGIA DEPARTMENT OF NATURAL RESOURCES. FOR MORE INFORMATION PLEASE VISIT <http://www.gadnr.org>.**

**ALL HOSPITAL LOCATIONS ARE PROVIDED BY THE GEORGIA DEPARTMENT OF COMMUNITY HEALTH. FOR MORE INFORMATION PLEASE VISIT <http://doh.doh.ga.gov>.**

**ALL PUBLIC K-12 SCHOOL LOCATIONS ARE PROVIDED BY THE GEORGIA GIS DATA CLEARINGHOUSE. FOR MORE INFORMATION PLEASE VISIT <http://www.gis.dca.state.ga.us>.**

**ALL NATIONAL PARK AND NATIONAL FOREST BOUNDARIES ARE PROVIDED BY THE NATIONAL PARK SERVICE. FOR MORE INFORMATION PLEASE CONTACT <http://www.nps.gov>.**

**ALL COMMUNITY LOCATIONS AND COUNTY SEAT LOCATIONS ARE PROVIDED BY THE UNITED STATES GEOLOGICAL SURVEY GEOGRAPHIC NAMES INFORMATION SYSTEM. FOR MORE INFORMATION PLEASE VISIT <http://geonames.usgs.gov>.**

**ALL FIRE STATION, LIBRARY, CORRECTIONAL FACILITY, LAW ENFORCEMENT, COURTHOUSE, COLLEGE, UNIVERSITY AND PRIVATE SCHOOL LOCATIONS ARE PROVIDED BY THE GEORGIA DEPARTMENT OF COMMUNITY AFFAIRS. FOR MORE INFORMATION PLEASE VISIT <http://www.dca.state.ga.us>.**

© 2011 GEORGIA DEPARTMENT OF TRANSPORTATION. ALL RIGHTS RESERVED. ANY REPRODUCTION IN PART OR IN WHOLE IS PROHIBITED UNLESS AUTHORIZED BY THE GEORGIA DEPARTMENT OF TRANSPORTATION.

**LEGEND**

Helipad	Unpaved Road
Welcome Center	County Road Number
County Boundary	Community
National/State Land	Airport Runway
Divided Highway	Interstate Route Number
National Register Historical Place	City Boundary (City Council Seat)
State Route Number	Paved Road
Military Reservation	County Seat
Lake	Weigh Station
Lighthouse	Library
Fish Hatchery	City Hall
Urban Area Boundary	Correctional Facility/Law Enforcement
Intermittent Stream	Rest Area
Perennial Stream	Swamp/Marsh
School	State Capitol
US Route Number	Hospital
Public Byway	Railroad
Scenic Byway	Projected Alignment
Frederation	Cemetery

GENERAL HIGHWAY MAP  
**ROCKDALE COUNTY**  
GEORGIA

PREPARED BY THE  
DEPARTMENT OF TRANSPORTATION  
OFFICE OF TRANSPORTATION DATA  
IN COOPERATION WITH  
U.S. DEPARTMENT OF TRANSPORTATION  
FEDERAL HIGHWAY ADMINISTRATION  
2011

0 0.25 0.5 1  
SCALE IN MILES (1" = 1/4 mile)

